

# User Manual

8028-ZFMT-ZWAVE

## 2. Performance parameters of product

Item	Parameter
Door unlocking mode	Z-wave, Fingerprint, card, code, mechanical key
Fingerprint read time	<1second
FRR	≤0.01%
FAR	≤0.0001%
User code capacity	100
Fingerprint capacity	100
User card capacity	100
Battery	4 x AA alkaline batteries (DC4.8 ~ 6.5V)
Low voltage alarm	5.0V (+0.2V)
Static current	20~70uA
Dynamic current	70mA
Working temperature	-20°C ~ 55°C
Storage temperature	-30°C ~ 70°C
Average Working time of trouble free	≥25,000h

## 3. Packing list

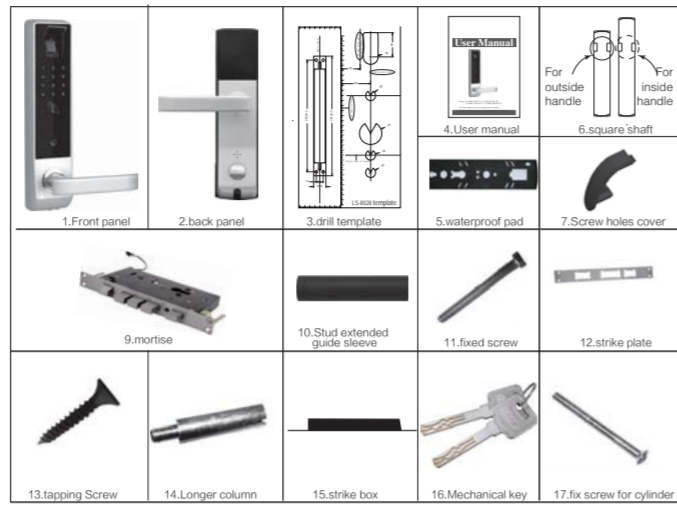

## 3. Drilling Template

Drilling template for 8028-ZFMT

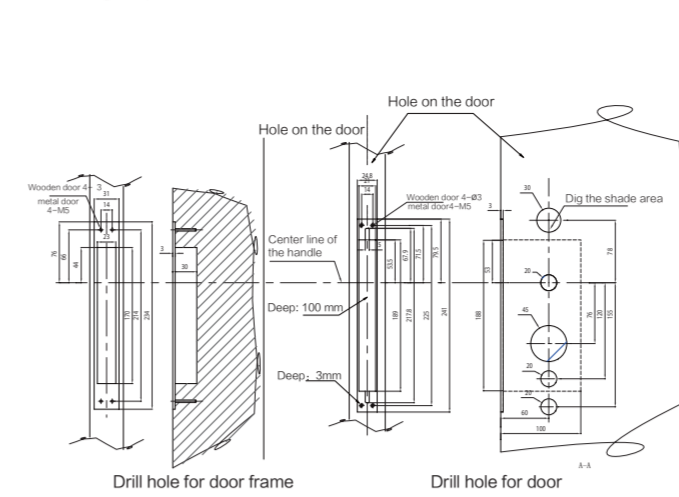

## 5. Change the front handle direction:

1. Press button A inside and keep it
2. Turn handle to left/right side

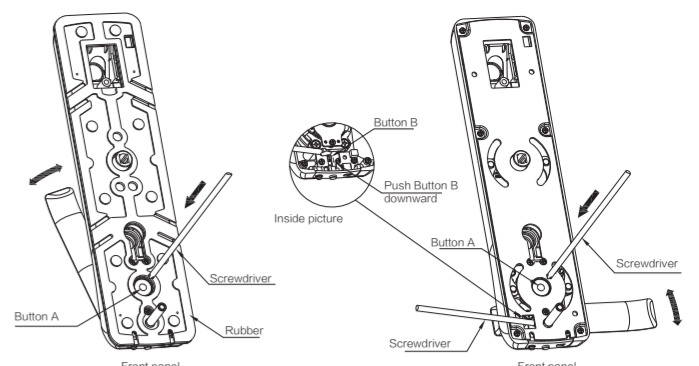

If you want to change front handle from left to right, or right to left, you need to use the button B and do followed steps:  
 A. Press button A inside and turn handle up to 60° direction, then keep to hold the handle and release button A  
 B. Push button B downward and turn the handle up to 90° direction, then release button B  
 C. Press button A inside and keep, turn the handle to right/left side

6. Change the back handle direction:  
 6.1. Push button B downward and keep it.  
 6.2. Turn handle to left/right side

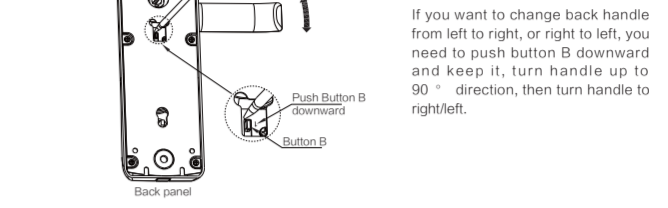

## III. Operation Guide

- ### 1. Keypad instructions
- Press "0-9" buttons for codes
  - Press "\*" for return or deletion
  - Press "#" for confirmation or wake up
  - There is a reset button on the back panel
  - When lock is in sleep model, touch keypad, press two keys lighting blue, wake up the lock.
- ### 2. Fingerprint
- Push away the fingerprint window cover and put your finger on the window after the voice prompt.
- ### 3. Quantity of fingerprint, card, code user
- Master code: 1 pcs (default master code: 123456)
  - Fingerprint: 100 pcs
  - Card: 100 pcs
  - Code: 100 pcs
- ### 4. Unlock method
- Fingerprint, code, card and mechanical key; fingerprint + code; card + code; card + fingerprint.
- ### 5. Door lock setting introduction
- #### 5.1. Change Master Code

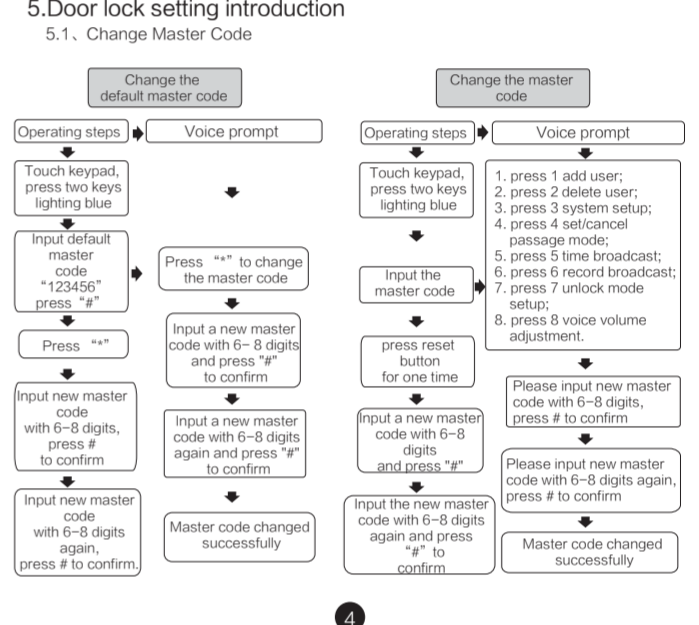

## I. Product introduction

### 1. Introduction

Model	8028-ZFMT-ZWAVE
Panel size	313 x 76 x 36mm
Material	Zinc alloy
Weight	6.5 K g

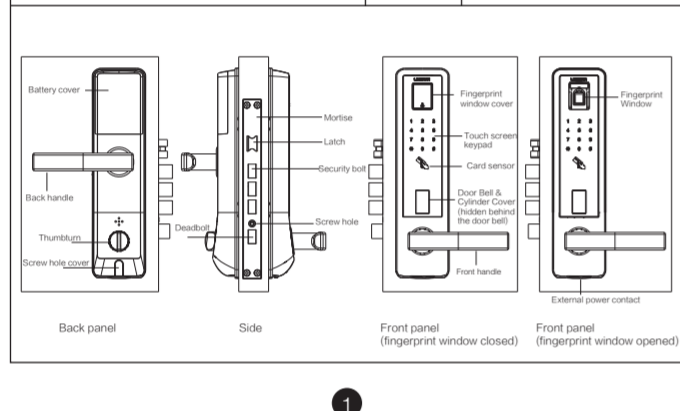

## II. Installation guide

### 1. Installation requirement

- 1.1. Door thickness requires
  - Lock edging ≥ 110mm (the door with different thickness)
  - 40mm ≤ door thickness ≤ 120mm (if door thickness ≤ 45mm or ≥ 120mm, it need customize parts)
- 1.2. Door Direction
  - Left hand(LH) door: people standing outside the door, facing the door, the door hinge on the left hand and push inward to open the door.
  - Right hand(RH) door: people standing outside the door, facing the door, the door hinge on the right hand and push inward to open the door.
  - Left hand reverse(LHR) door: people standing outside the door, facing the door, the door hinge on the left hand and pull outward to open the door.
  - Right hand reverse(RHR) door: people standing outside the door, facing the door, the door hinge on the right hand and pull outward to open the door.

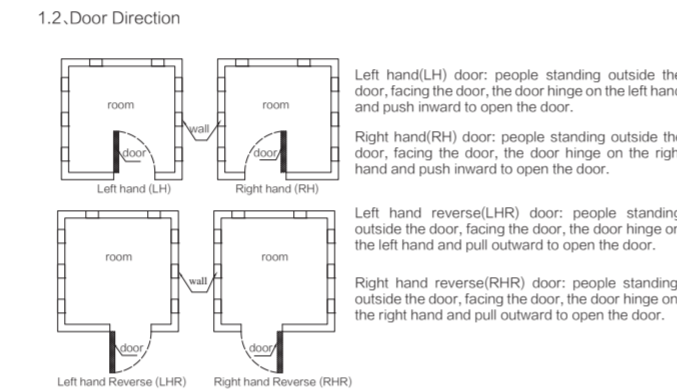

### 2. Tools

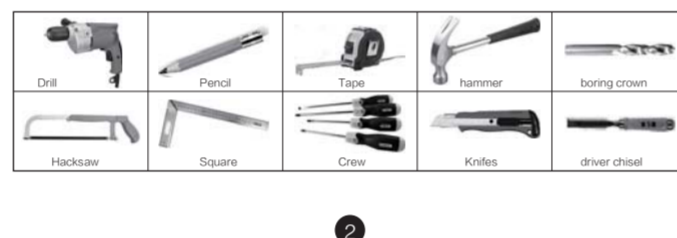

## 4. Installation step

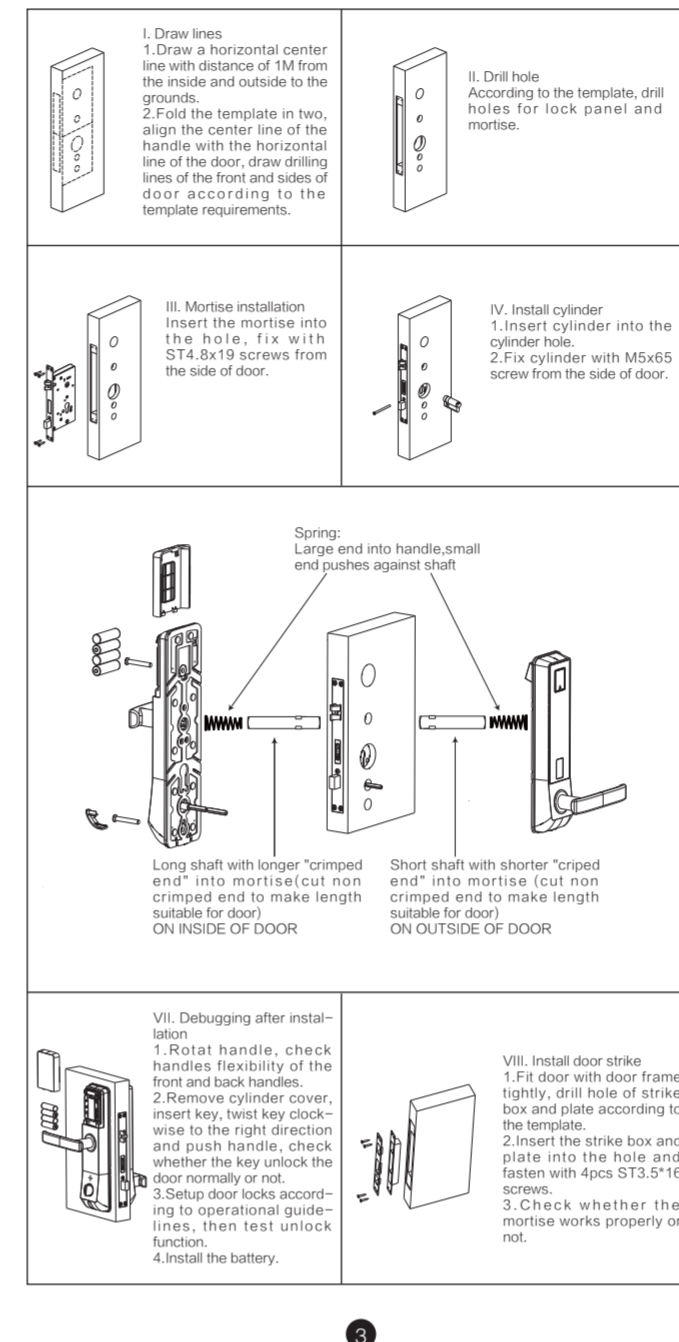

- Card, code, fingerprint can only be added after the factory default master code modified.
- New master code should be different with the default master code.
- When modify default master code, the first input code should be same with the second input code.

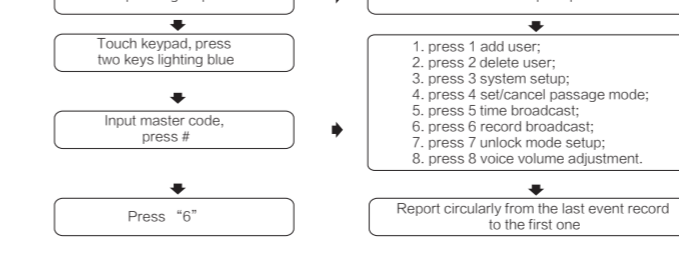
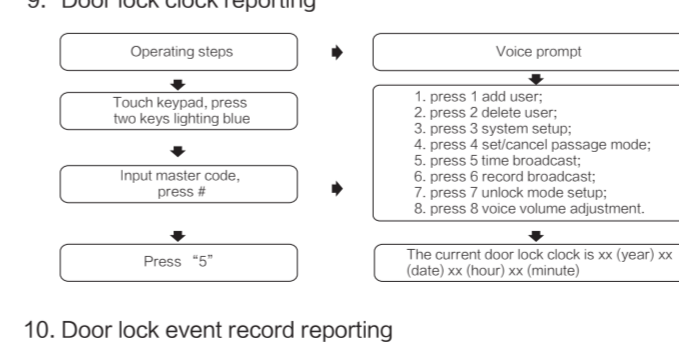
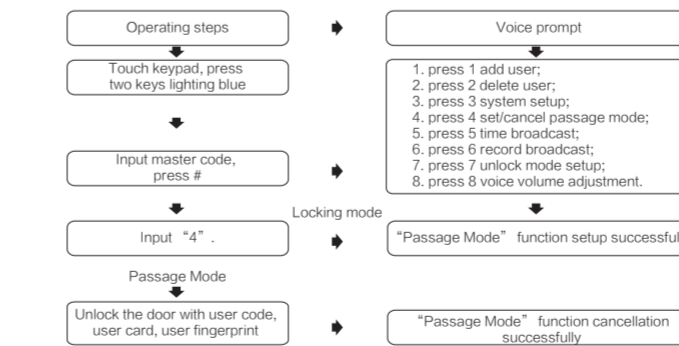
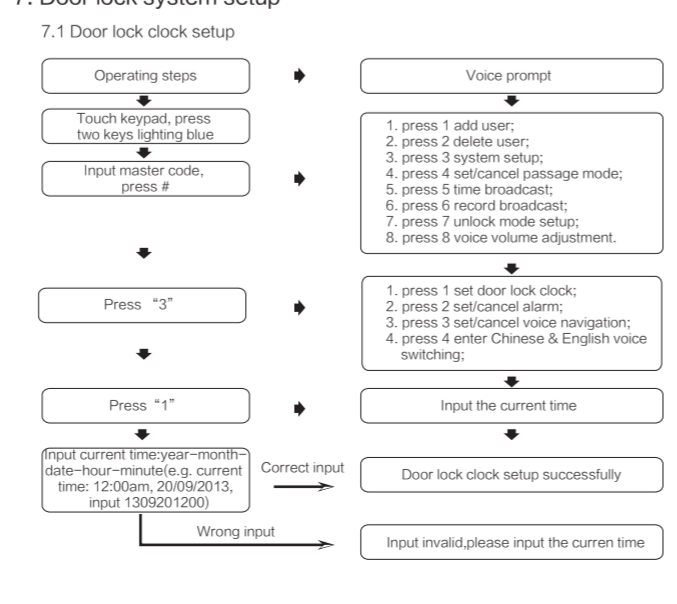
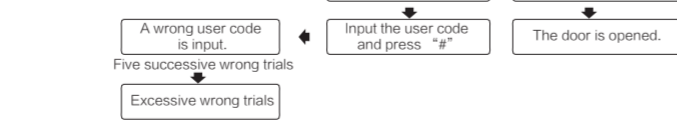
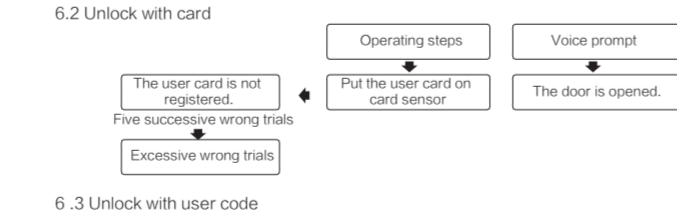
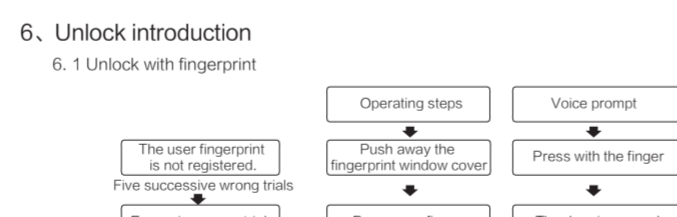
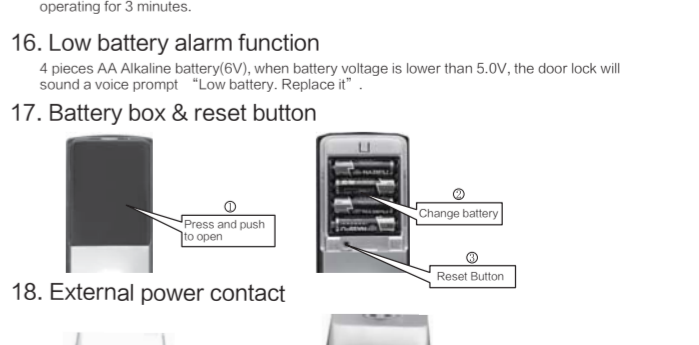
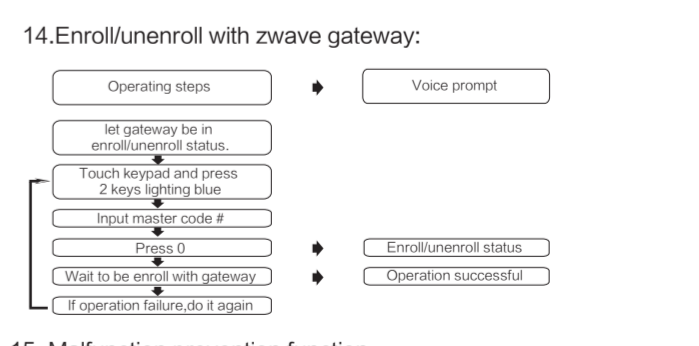
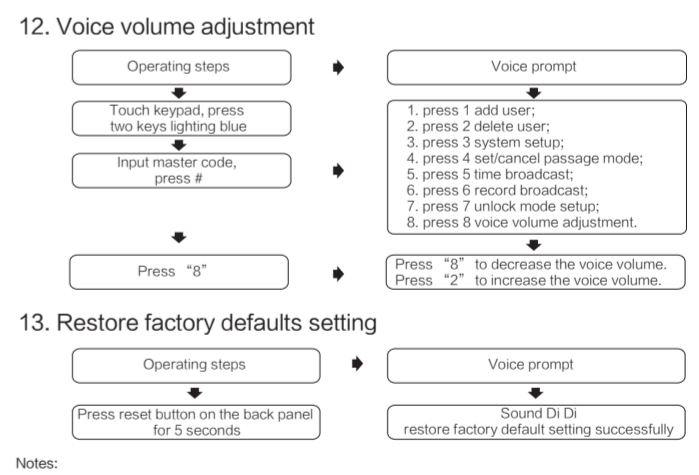
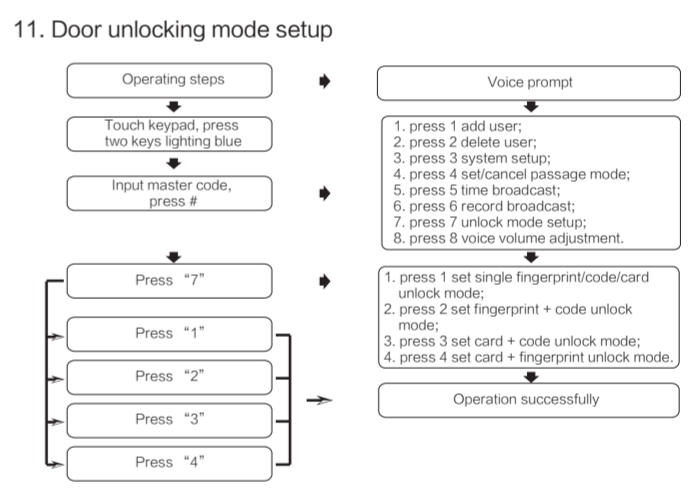
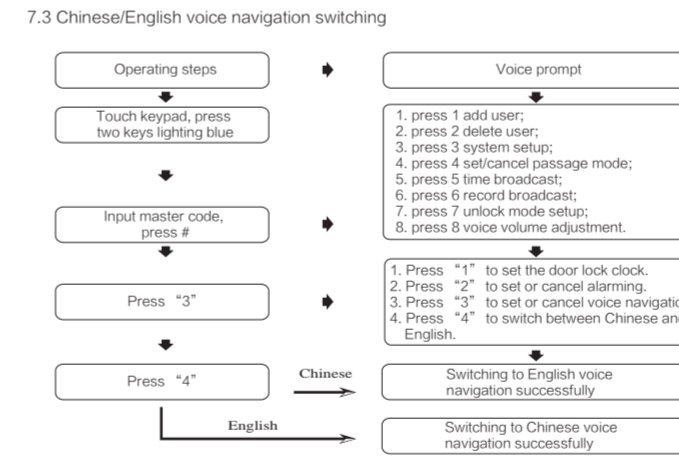
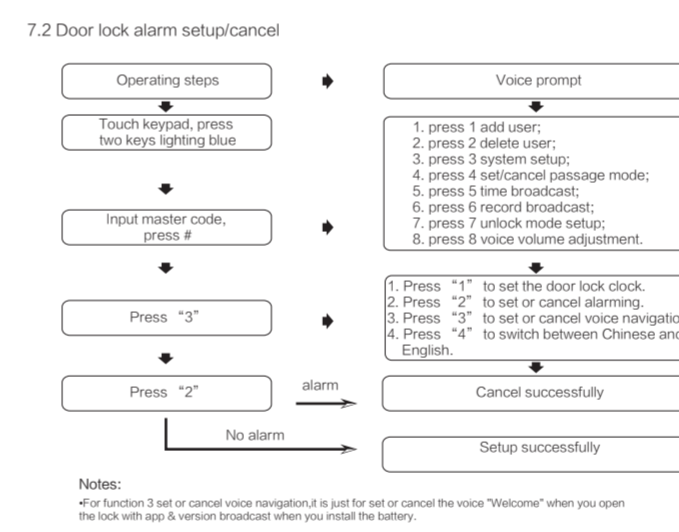
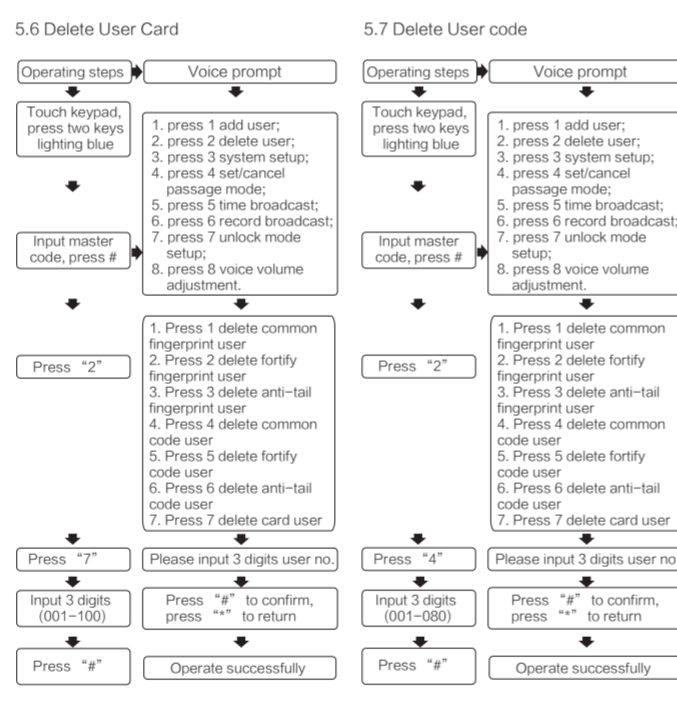
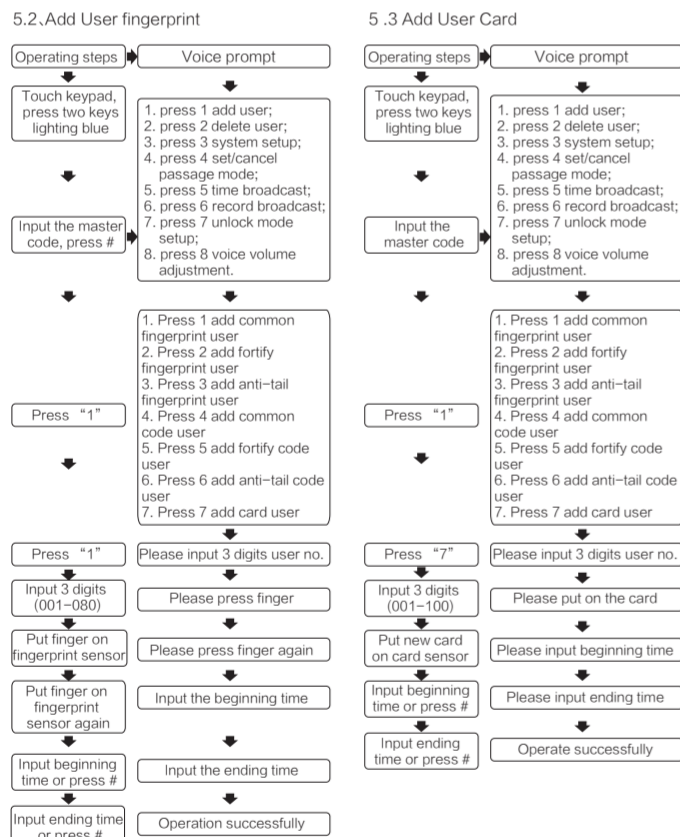

**Notes:**  
 \*Time format: "(year)"(date)"(hour)"(minute) e.g. 13113030, Nov. 2013  
 \*If you don't want fingerprint user with time restriction, please don't input time, press "\*" directly  
 \*Common fingerprint user index No. is 001-080  
 \*Fortify code user index No. is 081-090  
 \*Anti-tail fingerprint user index No. is 091-100  
 \*Common code user is same as anti-tail fingerprint user.  
 \*Fortify code user is set for unlocking lock. It needs to work with a special alarm.

**Notes:**  
 \*In the card adding status, you can delete more card users continually.  
 \*If you don't want card user with time restriction, please don't input time, press "\*" directly.  
 \*In the password delete status, you can delete more user code continually.

**Notes:**  
 \*For function 3 set or version broadcast, it is just for set or cancel the voice "Welcome" when you open the lock with app & on call broadcast when you install the battery.

**Notes:**  
 \*After the default master code is restored, it must be changed before user adding or deletion.  
 \*After factory defaults are restored, the previously set fingerprints, user cards, user codes will be all cleared and can no longer be used.

\*Common code user index No. is 001-080  
 \*Fortify code user index No. is 081-090  
 \*Anti-tail code user index No. is 091-100  
 \*Common code user is same as anti-tail fingerprint user.  
 \*Fortify code user is set for unlocking lock. It needs to work with a special alarm.